

**R-1916 Series
Watertight Manhole Frame,
Bolted Lid**

Heavy Duty

Gasket sealed and bolted lid (stainless steel bolts are standard) make this casting ideal for subaqueous installation. For built-up manholes only. Also suited for low pressure, gas or steamtight application up to 20 psi. For higher pressure application, please send specifications. Lids furnished with Type "F" concealed pickholes (see p.16). Units are furnished with four 1" anchor holes – anchor bolts not furnished. Units are shipped assembled with T-gasket glued to lid, except **R-1916-A** and **R-1916-B**, which have flat gasket. Note: Bolting pads reduce effective clear opening (Dimension C) by 2" to 3". If "C" dimension is critical, select larger size. See **R-6462 Series** for more watertight units in 4" height.

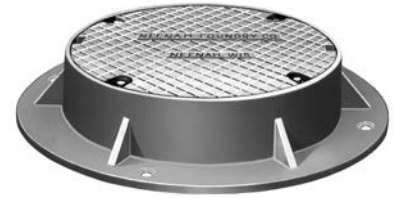
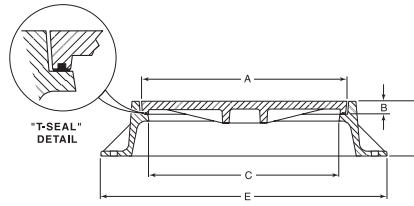

Illustrating R-1916-F

Dimensions in inches

Catalog No.	A	B	C	E	F	Cover Bolt Quantity	Anchor Bolt Circle
R-1916-A	12	1 1/8	11	19	4	4	17
R-1916-B	18	1	17	25	4 1/2	4	22
R-1916-C	23	1 1/2	21	36	9	4	30
R-1916-C1	24	1 3/8	20 5/8	31	6	6	28
R-1916-D	24	1 1/2	21 5/8	35	7 1/2	4	31-3/4
R-1916-E	25	1 1/2	23	38	9	4	34
R-1916-F	26	1 1/2	24	36	7	4	33
R-1916-H	32	1 1/2	30	46	7	6	42
R-1916-H1	31 3/4	1 3/4	30	39 1/4	6	4	36-1/4
R-1916-K	38	1 1/2	36	49	10	6	46

**R-1916-C2
Water-Resistant Manhole Frame,
Bolted Lid**

Heavy Duty

Standard frame is furnished with twelve 1-1/2" anchor holes on 31" diameter bolt circle. Note: Frame is also available with four 1" anchor holes on 31" diameter bolt circle. Furnished only when specified.

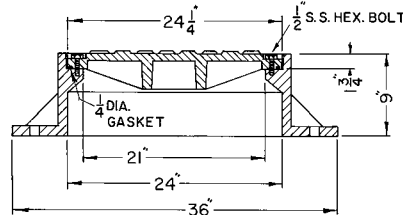

**R-1916-T
Water-Resistant Manhole Frame,
Gasket, Bolted Lid**

Heavy Duty

Furnished with four 1" anchor holes on 32" diameter bolt circle. Four 1" wide slots for anchor bolts. Furnished with machined horizontal and vertical bearing surfaces. Units are shipped assembled with gasket glued to frame.

